

Part Number: 280

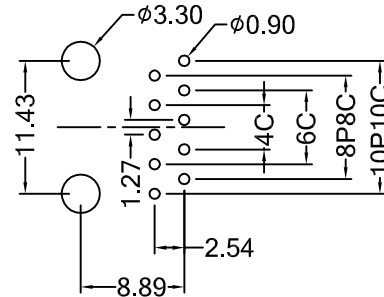

PCB LAYOUT / TOP VIEW

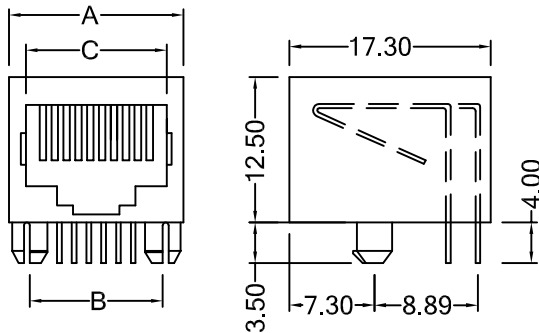
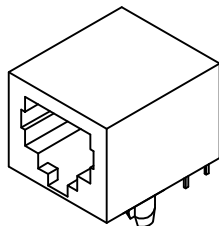
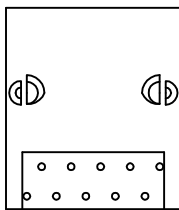

position	contact	A	B	C
4P	4C	15.00	11.43	8.00
6P	2C/4C/6C	15.00	11.43	9.90
8P	4C/6C/8C	15.00	11.43	11.90
10P	10C	15.00	11.43	11.90

MATERIAL & FINISH

Housing & Insert: PBT or Nylon 9T, UL94V-0, black
 Contact: 0.35 mm thickness phosphor bronze,
 Gold plated over nickel on contact area,
 Tin plated over nickel on solder area.
 Temperature: -40°C to 85°C
 Mating Cycle: 750 min.

ELECTRICAL SPECIFICATIONS

Voltage: 125 VAC
 Current: 1.5 A
 Contact Resistance: 30 milliohms max.
 Insulation Resistance: 500 megaohms min.
 Dielectric Withstanding Voltage: 1000 VAC

ORDERING INFORMATION

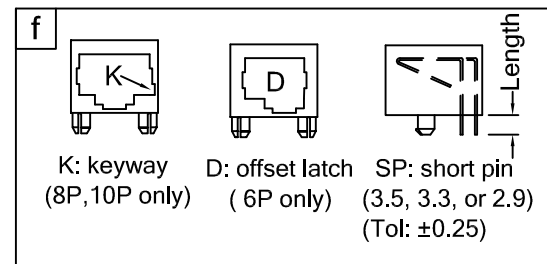
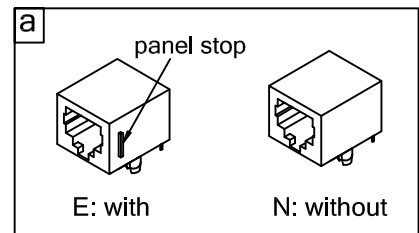
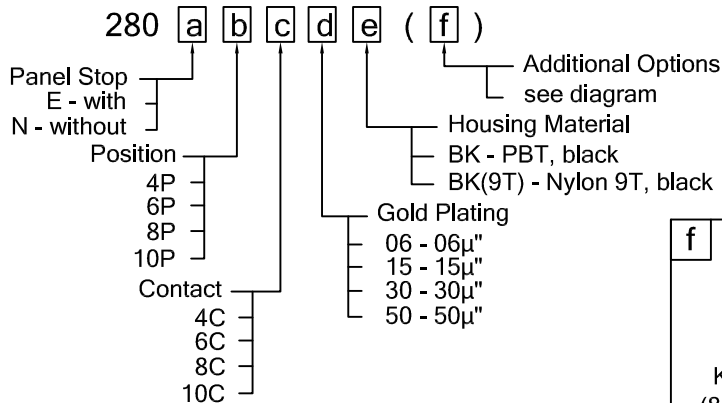

UNIT: m / m
 TOL.: ±0.15 unless otherwise stated



巨亮企業有限公司
 CHU LIANG ENTERPRISE CO.,LTD.
 TEL:886-2-22023997 FAX:886-2-22023867

E-mail: web@plug.com.tw
 peter@plug.com.tw
 Web: http://www.plug.com.tw